

## 71/88 Pitt Street Sydney NSW

- Impressive commercial office suite
- Brilliant location near Wynyard Station
- Highrise positioning and excellent light
- Attractive views overlooking Martin Place
- Quality finishes including timber shutters
- Separate reception and meeting room
- Efficient layout with open work spaces
- Individually controlled air conditioning
- Access to a large rooftop terrace area
- Modern and stylish commercial building
- Striking main lobby with digital directory
- Convenient to all major transport hubs
- Close to Circular Quay and Wynyard
- Multiple car parking options nearby
- Prestigious and high profile location

**Building Size** : 42 sqm  
**View** : <https://www.noonanproperty.com.au/lease/nsw/sydney-city/sydney/commercial/offices/5999025>



**Tim Noonan**  
**02 9231 6000**

Size - 42 sqm approx

**Suite 71, 88 Pitt Street,  
SYDNEY**

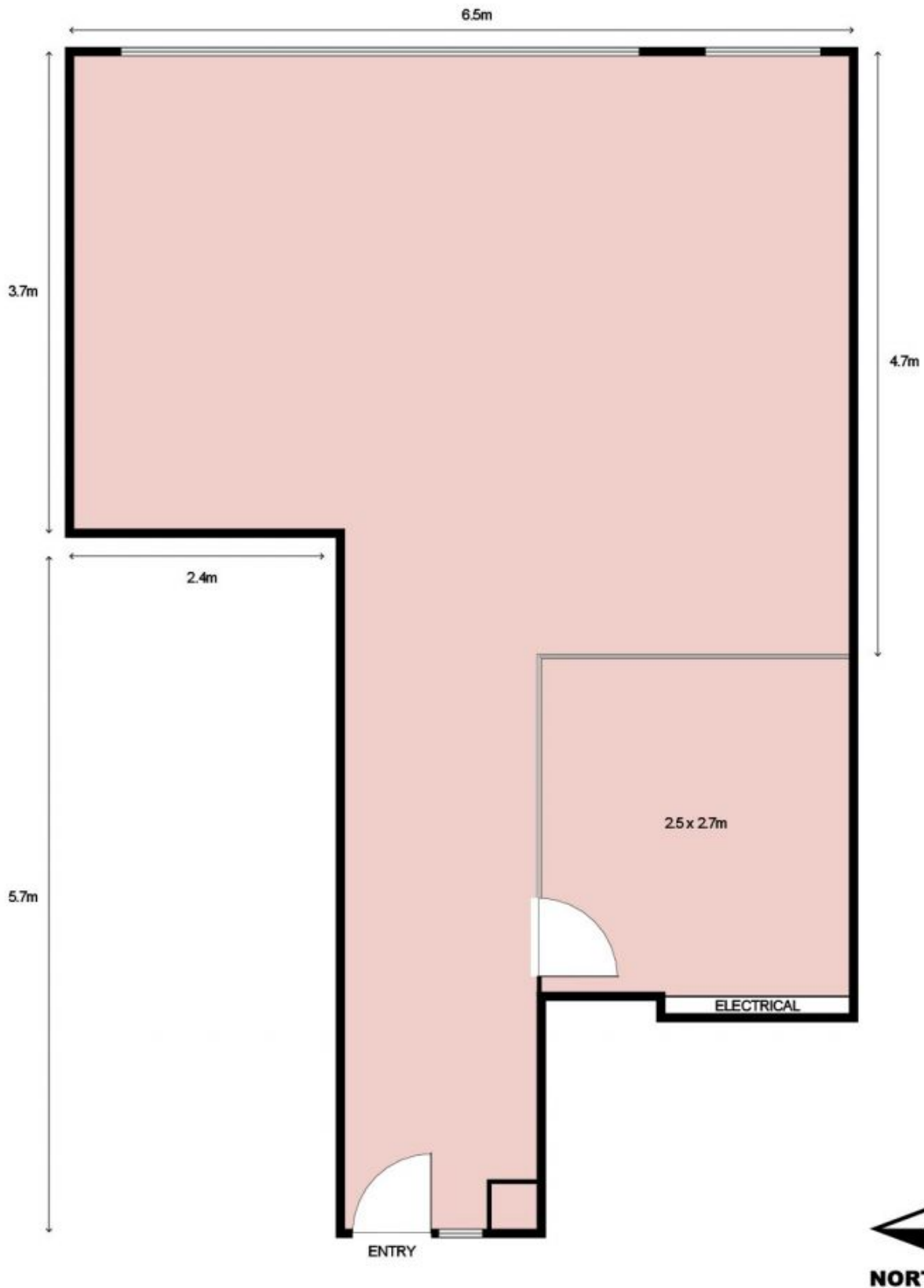

This floor plan is intended as a guide only. Layout dimension are approximate only. No representation or warranties of any nature whatsoever are given or intended. Any person using this information should rely on their own enquiries.

# Suite 71, 88 Pitt Street, SYDNEY

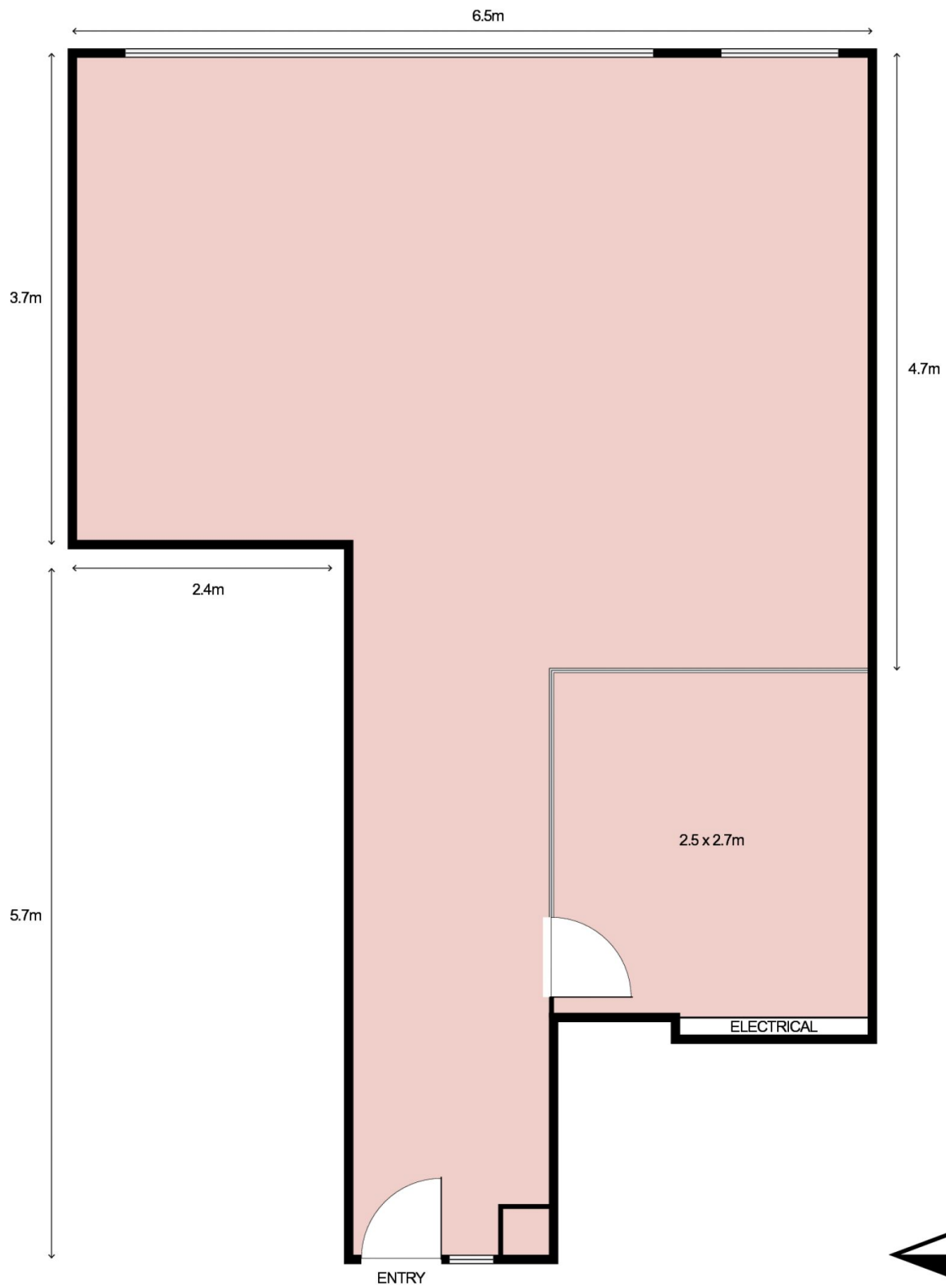

**NORTH**

This floor plan is intended as a guide only. Layout dimension are approximate only. No representation or warranties of any nature whatsoever are given or intended. Any person using this information should rely on their own enquiries.