



Level 2/131 Clarence Street Sydney NSW

- Creative and impressive commercial space
- Quality fitout with polished concrete floors
- High ceilings and excellent natural light
- Full height windows overlooking Kent Street
- Exclusive balcony with entire building frontage
- Striking reception and boardroom area
- Internal kitchens and on floor bathrooms
- Modern boutique commercial building
- Contemporary lobby with impressive finishes
- Landmark location in major growth precinct
- Minutes to Wynyard Walk and Martin Place
- Close to Circular Quay and Wynyard Stations
- Gateway positioning for Barangaroo
- Next door to Machiavelli Ristorante

Building Size : 200 sqm

View : <https://www.noonanproperty.com.au/lease/nsw/sydney-city/sydney/commercial/offices/5999062>



Tim Noonan
02 9231 6000

Size - 200 sqm approx.

Level 2, 131 Clarence Street, SYDNEY

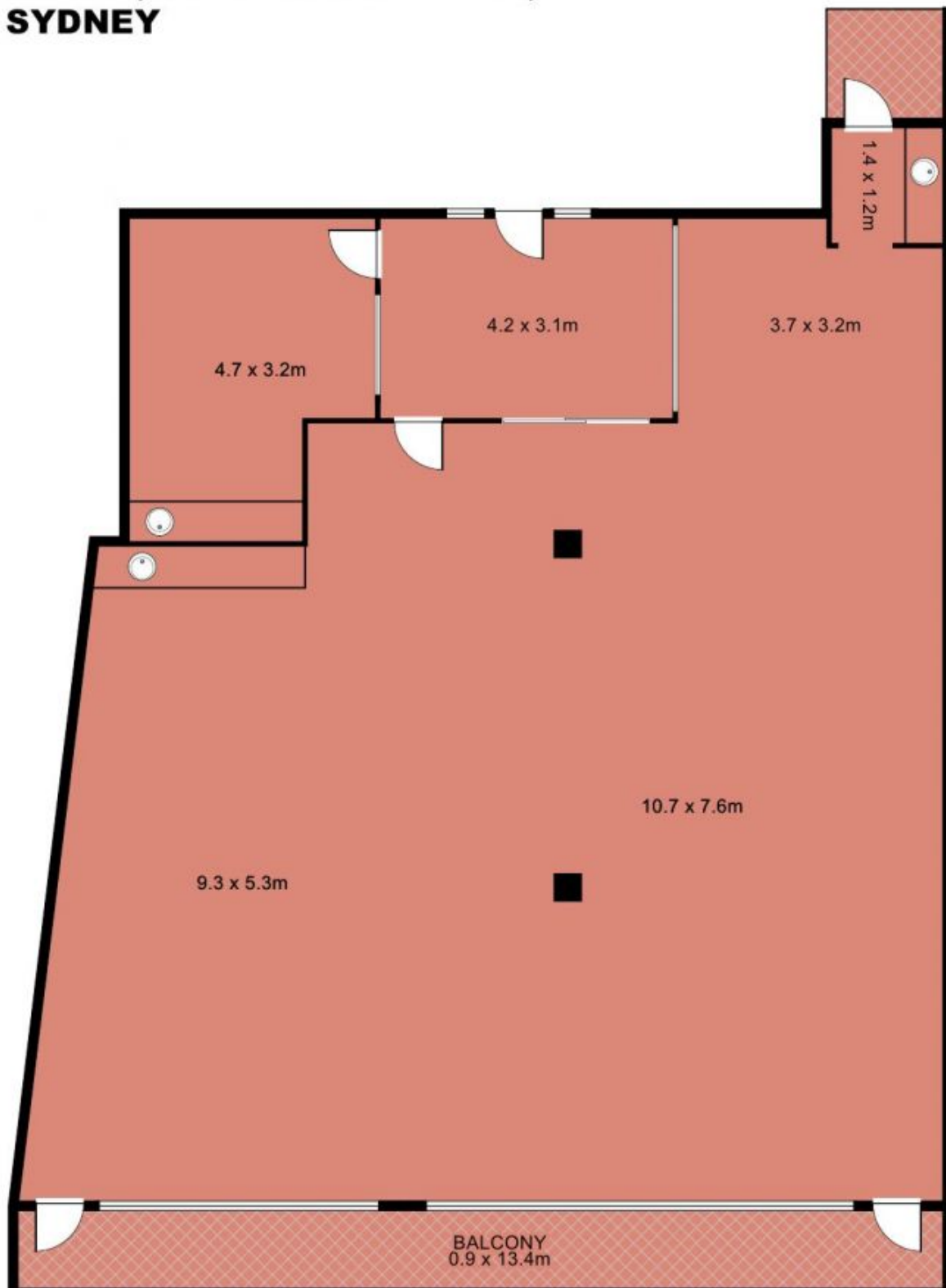

NORTH

This floor plan is intended as a guide only. Layout dimension are approximate only. No representation or warranties of any nature whatsoever are given or intended. Any person using this information should rely on their own enquiries.

Level 2, 131 Clarence Street, SYDNEY

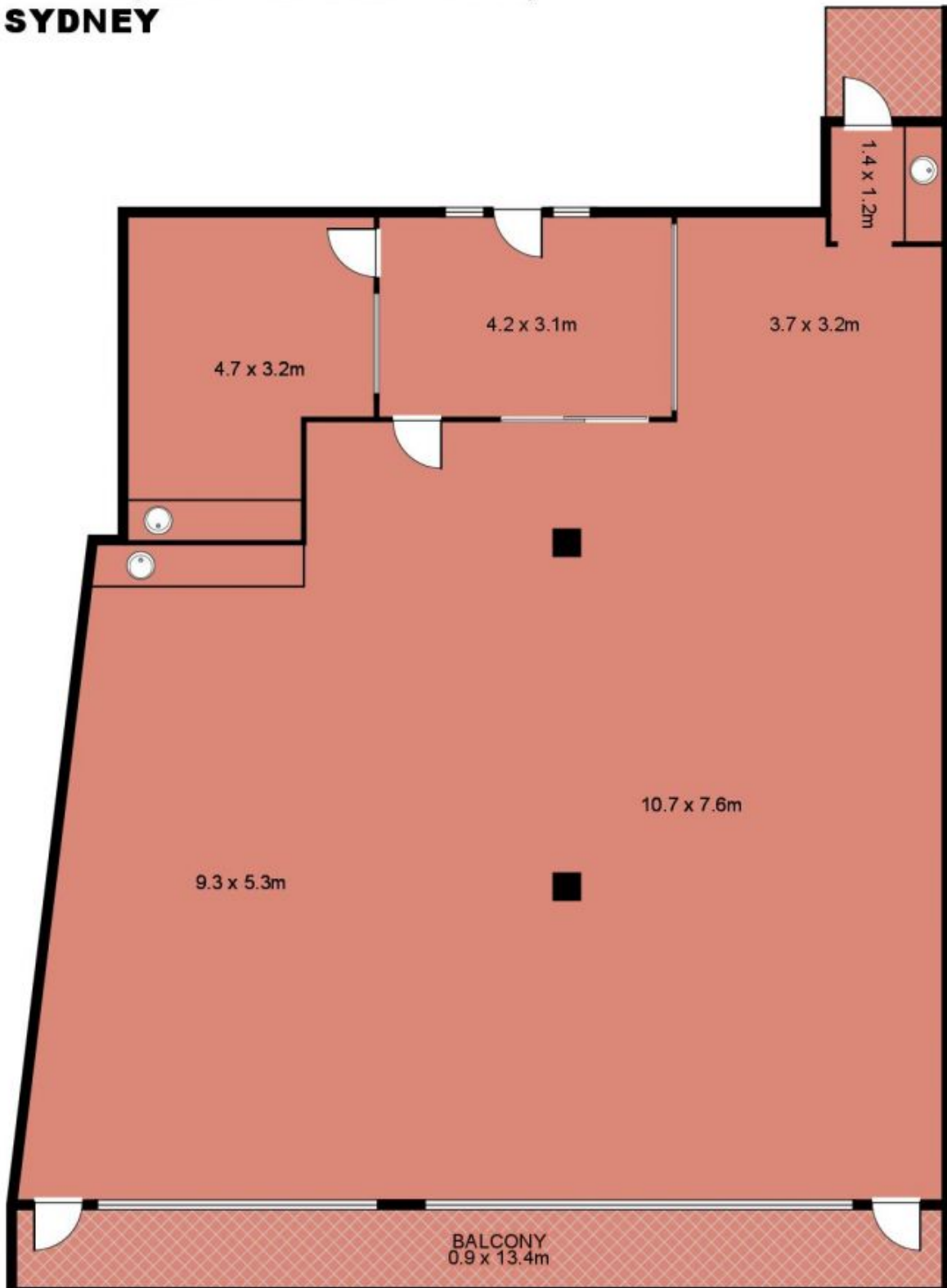

This floor plan is intended as a guide only. Layout dimension are approximate only. No representation or warranties of any nature whatsoever are given or intended. Any person using this information should rely on their own enquiries.