



109 Pitt Street Sydney NSW

- Modern and impressive commercial suite
- Open plan with functional and efficient layout
- Freshly painted and new carpeting throughout
- Ready for immediate occupation or new fitout
- North facing aspect with good natural light
- Direct and prominent lift lobby exposure
- High quality and prominent commercial building
- State of the art recently renovated main lobby
- Excellent building services including six lifts
- Shower facilities and onsite management
- On site basement car parking available
- Direct undercover access to Wynyard Station
- Landmark location near Martin Place
- Close to Circular Quay and Australia Square
- Direct link to Wynyard Walk and Barangaroo

Building Size : 64 sqm

View : <https://www.noonanproperty.com.au/lease/nsw/sydney-city/sydney/commercial/offices/5999196>



Tim Noonan
02 9231 6000

Size - 64 sqm approx.

**Suite 605, 109 Pitt Street,
SYDNEY**

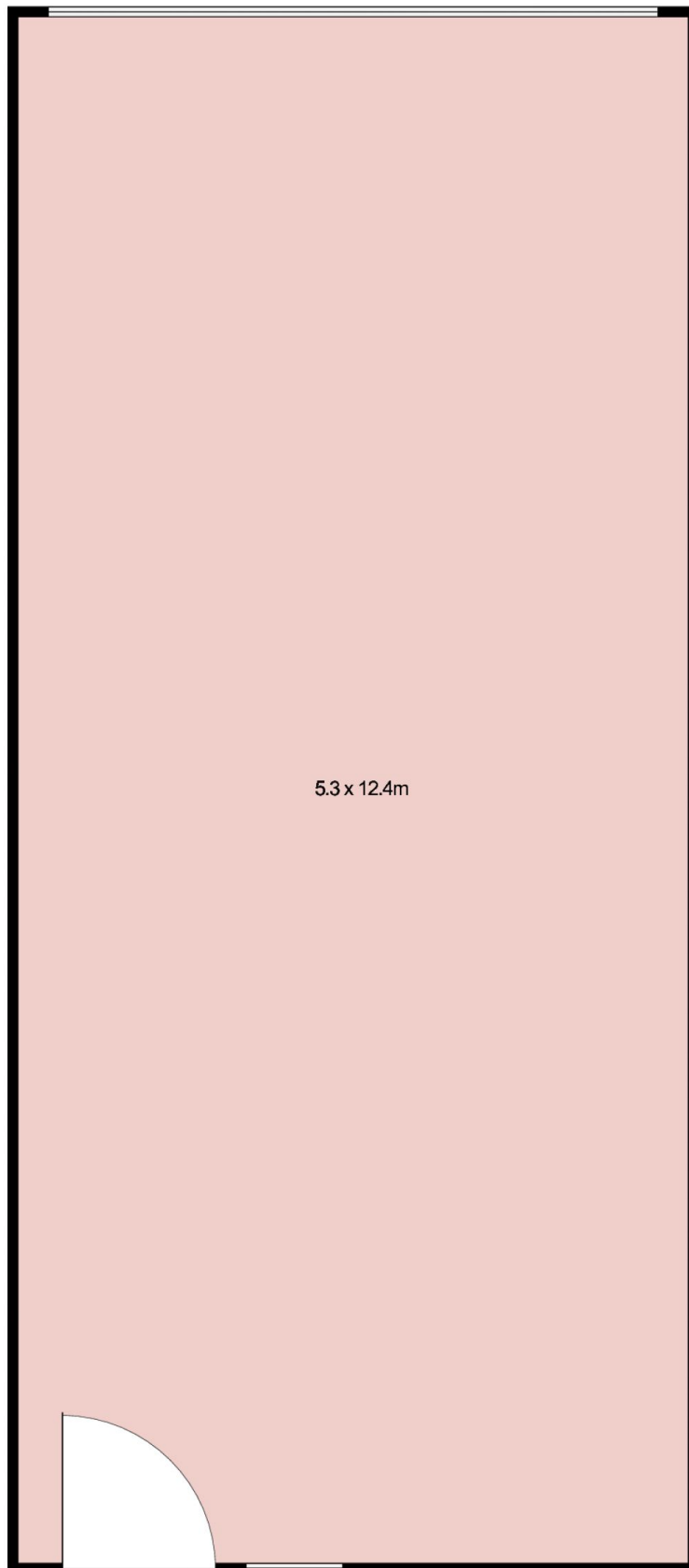

This floor plan is intended as a guide only. Layout dimension are approximate only. No representation or warranties of any nature whatsoever are given or intended. Any person using this information should rely on their own enquiries.

**Suite 605, 109 Pitt Street,
SYDNEY**

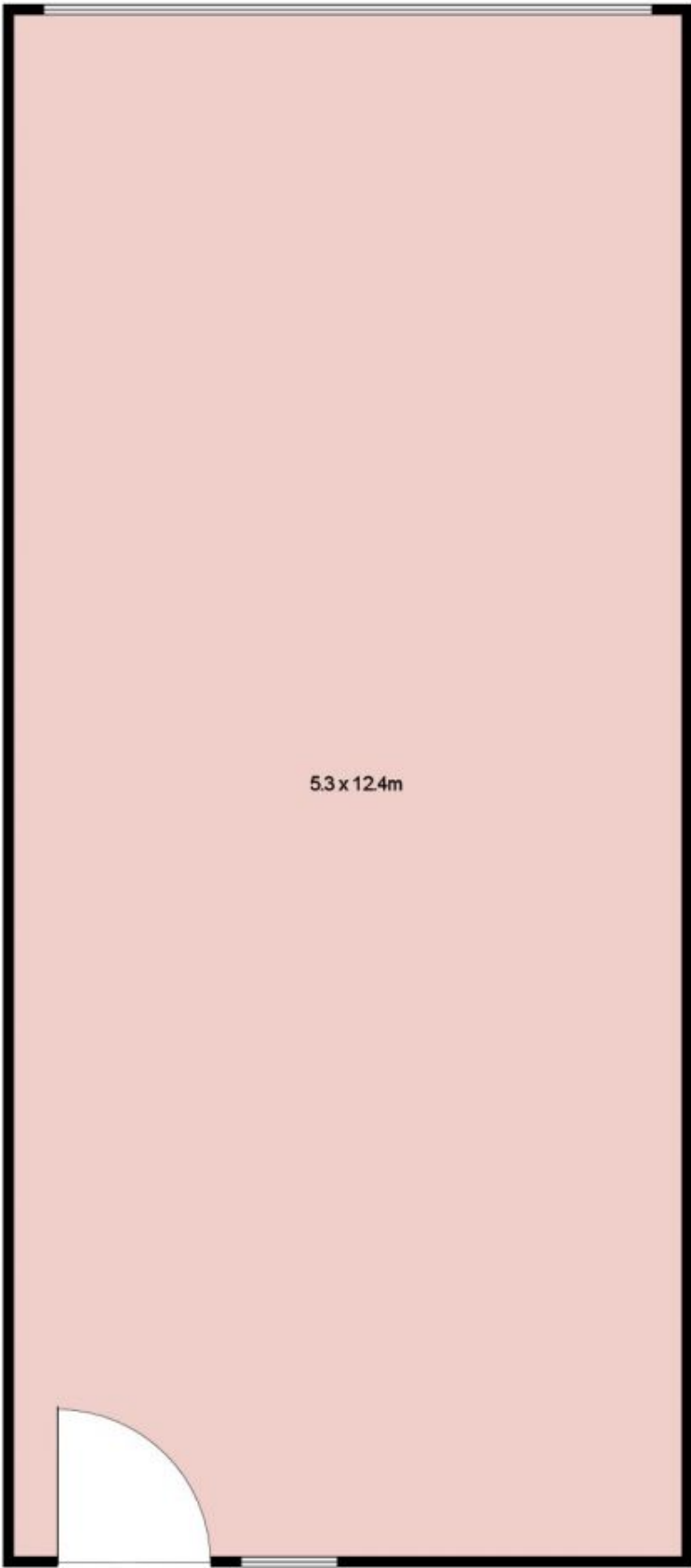

This floor plan is intended as a guide only. Layout dimension are approximate only. No representation or warranties of any nature whatsoever are given or intended. Any person using this information should rely on their own enquiries.