



606/50 Clarence Street Sydney NSW

- Modern and impressive commercial suite
- Stylish, professional and efficient workspace
- Large windows and excellent natural light
- 2 large executive offices or meeting rooms
- Bespoke fit-out with glass partitioning
- Large open plan area with 6 workstations
- Internal kitchenette with integrated storage
- Onsite shower and change room facilities
- Modern and prominent commercial building
- Impressive main lobby area with three lifts
- Surrounded by popular restaurants and bars
- Close to Wynyard, Martin Place and Barangaroo

50 Clarence Street is a highly regarded quality commercial building in a superb location next door to Wynyard Station. This distinguished position is a leading business address and a significant growth precinct due to its close proximity

Building Size : 67 sqm
View : <https://www.noonanproperty.com.au/lease/nsw/sydney-city/sydney/commercial/offices/5999214>



Tim Noonan
02 9231 6000

Suite 606, 50 Clarence Street, SYDNEY

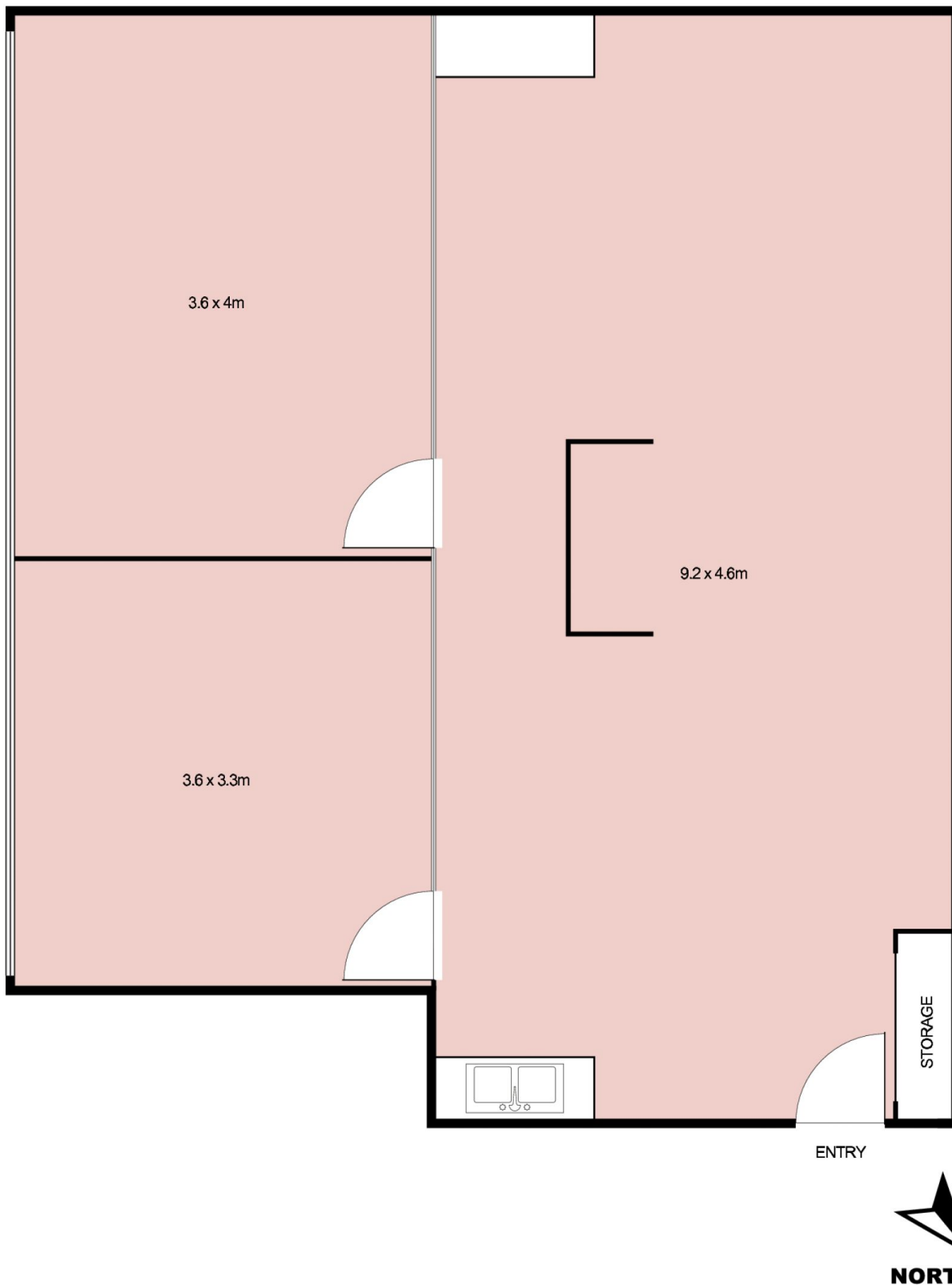

This floor plan is intended as a guide only. Layout dimension are approximate only. No representation or warranties of any nature whatsoever are given or intended. Any person using this information should rely on their own enquiries.

Suite 606, 50 Clarence Street, SYDNEY

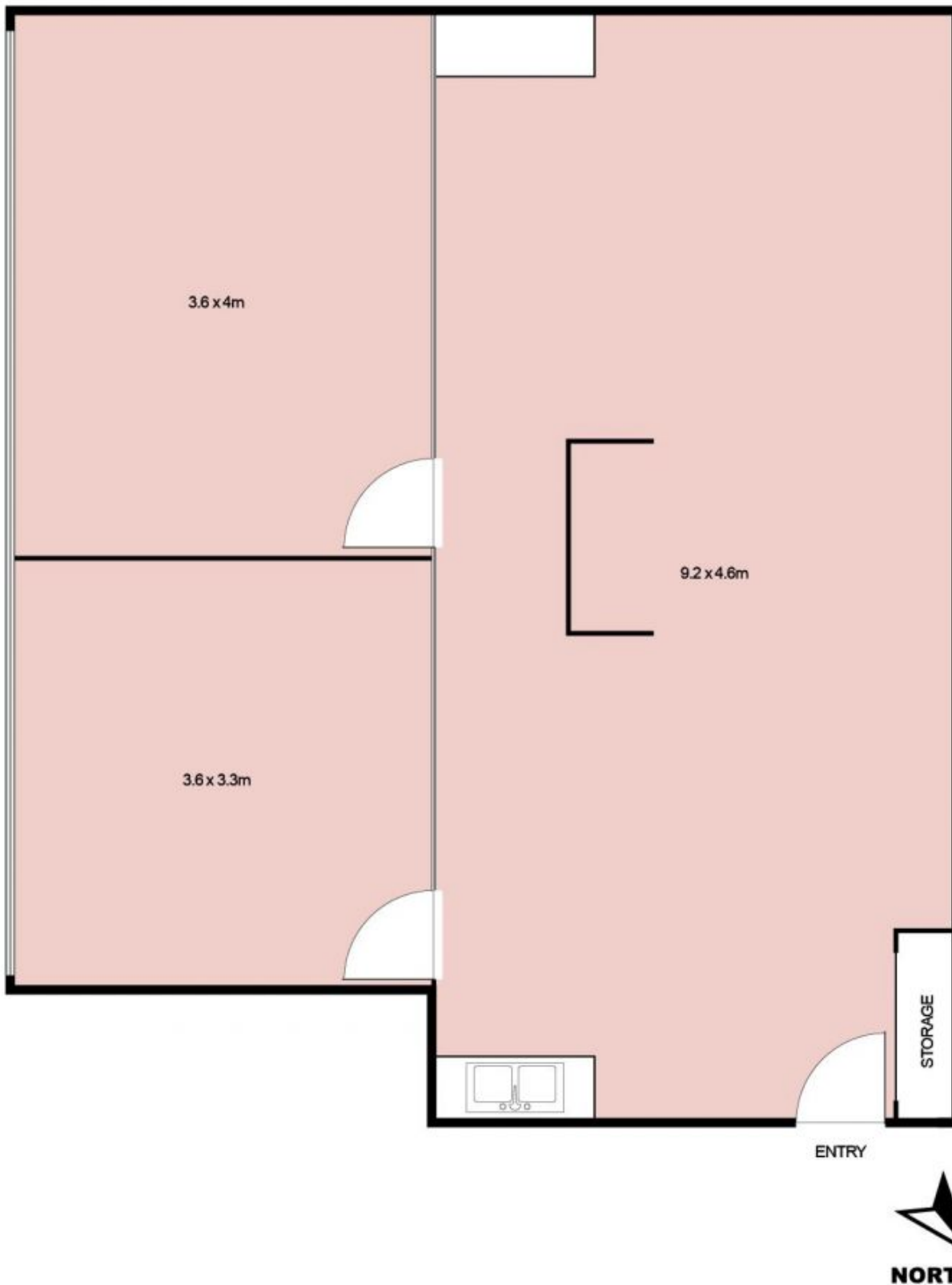

This floor plan is intended as a guide only. Layout dimension are approximate only. No representation or warranties of any nature whatsoever are given or intended. Any person using this information should rely on their own enquiries.