



## 1010/155 King Street Sydney NSW

- Prestigious commercial or professional suite
- Penthouse positioning and extra high ceilings
- Superbly presented with excellent natural light
- Basement storage unit 6m<sup>2</sup> available if required
- Freshly painted and new carpeting throughout
- Excellent aspect overlooking Castlereagh Street
- Cityscape views of MLC Centre and CBD skyline
- Iconic building with classic Heritage features
- Imposing main lobby area with stately finishes
- Excellent building services including three lifts
- Envious positioning on Sydney's 'Rodeo Drive'
- Close to Circular Quay, Wynyard and Martin Place
- Minutes to Queen's Square and Hyde Park
- Blue ribbon location opposite the MLC Centre

**Building Size** : 25 sqm

**View** : <https://www.noonanproperty.com.au/lease/nsw/sydney-city/sydney/commercial/offices/5999225>



**Tim Noonan**  
02 9231 6000

Size - 25 sqm approx.

**Suite 8, Level 10, 155 King Street,  
SYDNEY**

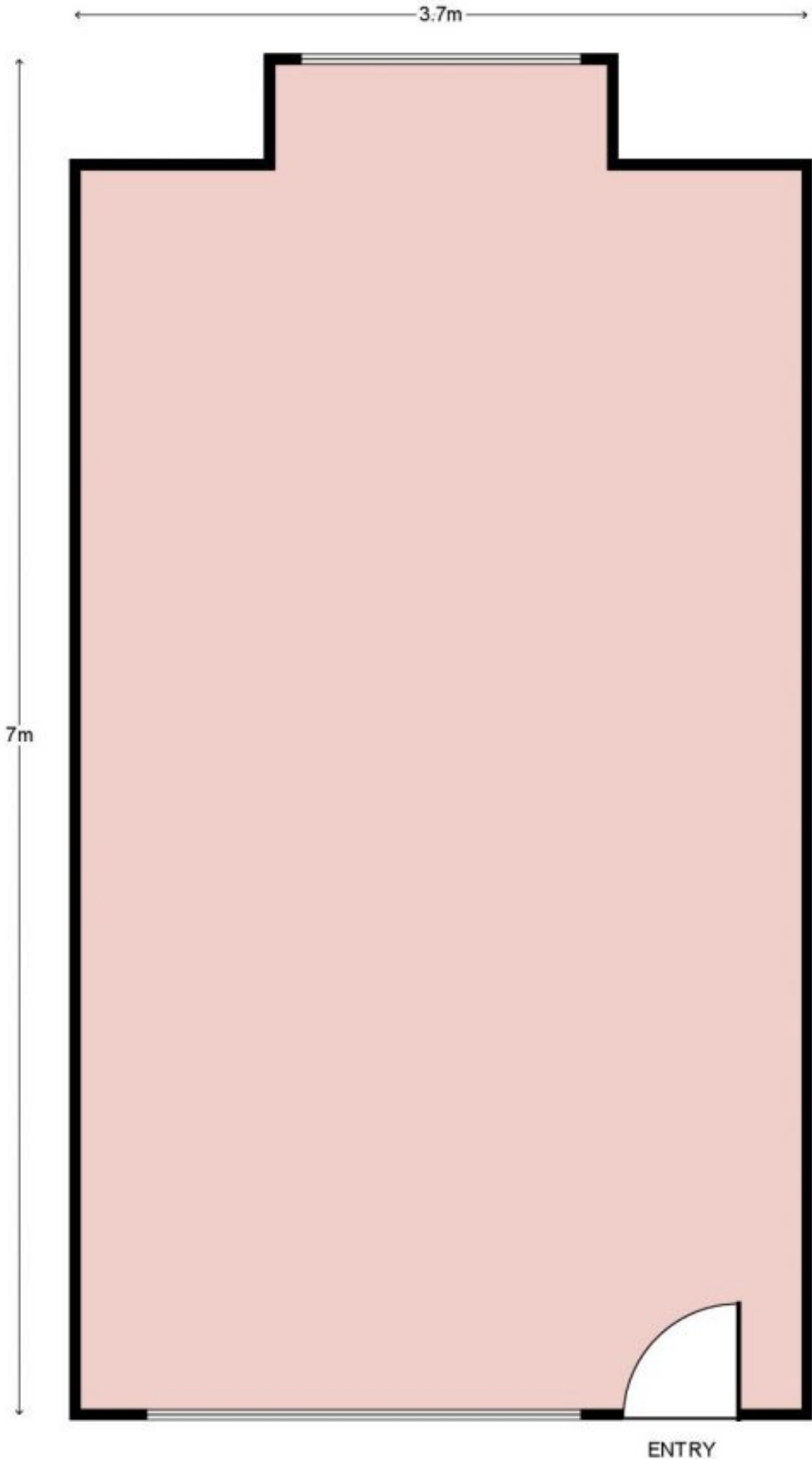

This floor plan is intended as a guide only. Layout dimension are approximate only. No representation or warranties of any nature whatsoever are given or intended. Any person using this information should rely on their own enquiries.