



705-706/50 Clarence Street Sydney NSW

Noonan Property has been exclusively appointed to offer for sale Suite 705-706 and Car Space 88, 50 Clarence Street, Sydney.

- Two adjoining office suites and one car space
- Three separate titles offering excellent flexibility
- Contemporary, impressive and vibrant workspace
- Expansive dual East and West window frontages
- Large windows providing excellent natural light
- Views overlooking Clarence Street and Barangaroo
- Adaptable fitout with custom joinery included
- Mixture of offices and open plan work spaces
- Direct and prominent lift lobby exposure
- Modern and stylish commercial building
- Striking main lobby with ultra-high ceilings
- Onsite shower and change room facilities
- Excellent building services including three lifts

Building Size : 170 sqm

View : <https://www.noonanproperty.com.au/sale/nsw/sydney-city/sydney/commercial/offices/5999227>



Tim Noonan
02 9231 6000

Level 7, Suite 705 and 706, 50 Clarence Street, SYDNEY

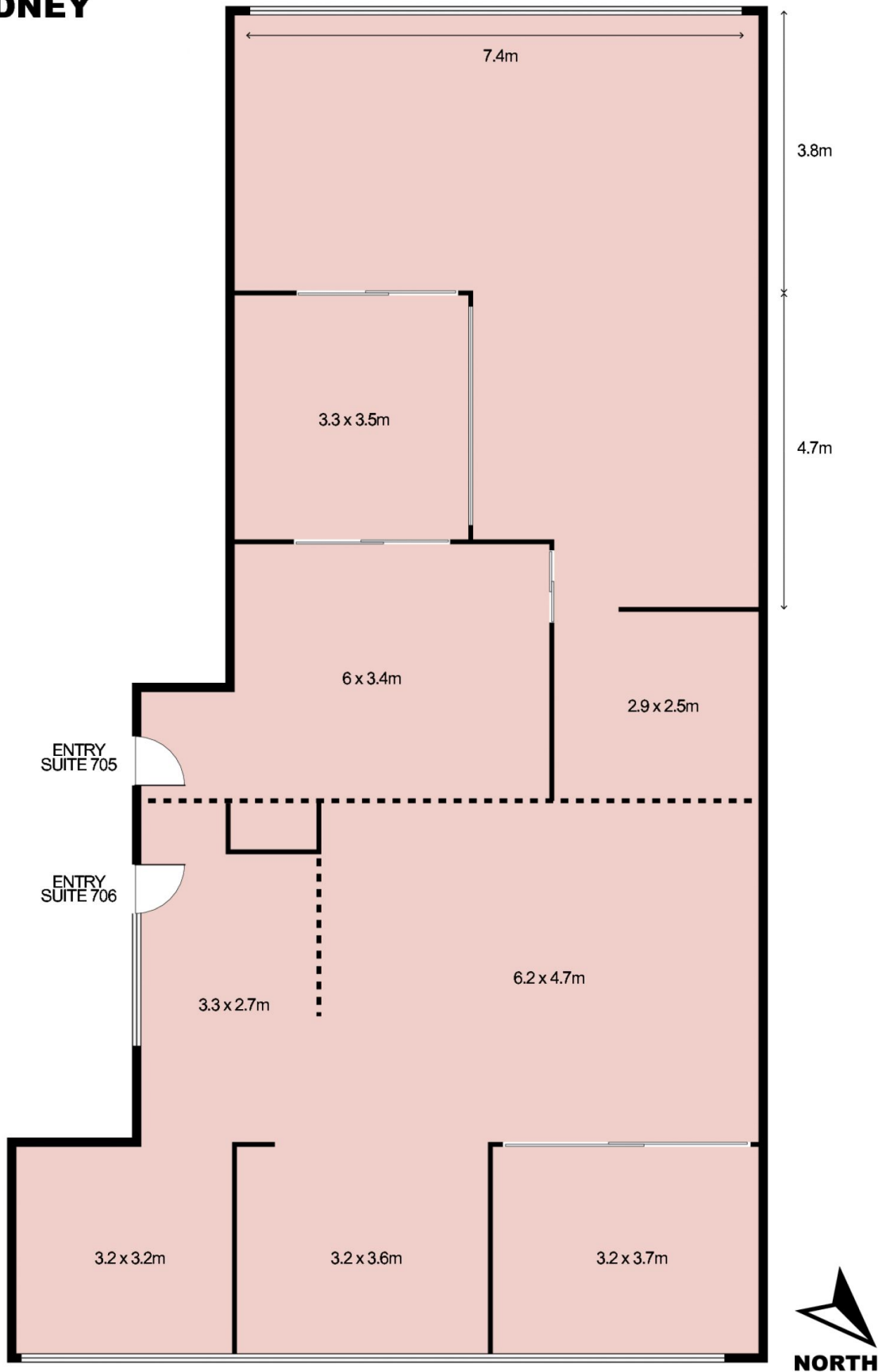

This floor plan is intended as a guide only. Layout dimension are approximate only. No representation or warranties of any nature whatsoever are given or intended. Any person using this information should rely on their own enquiries.

**Level 7, Suite 705 and 706, 50 Clarence Street,
SYDNEY**

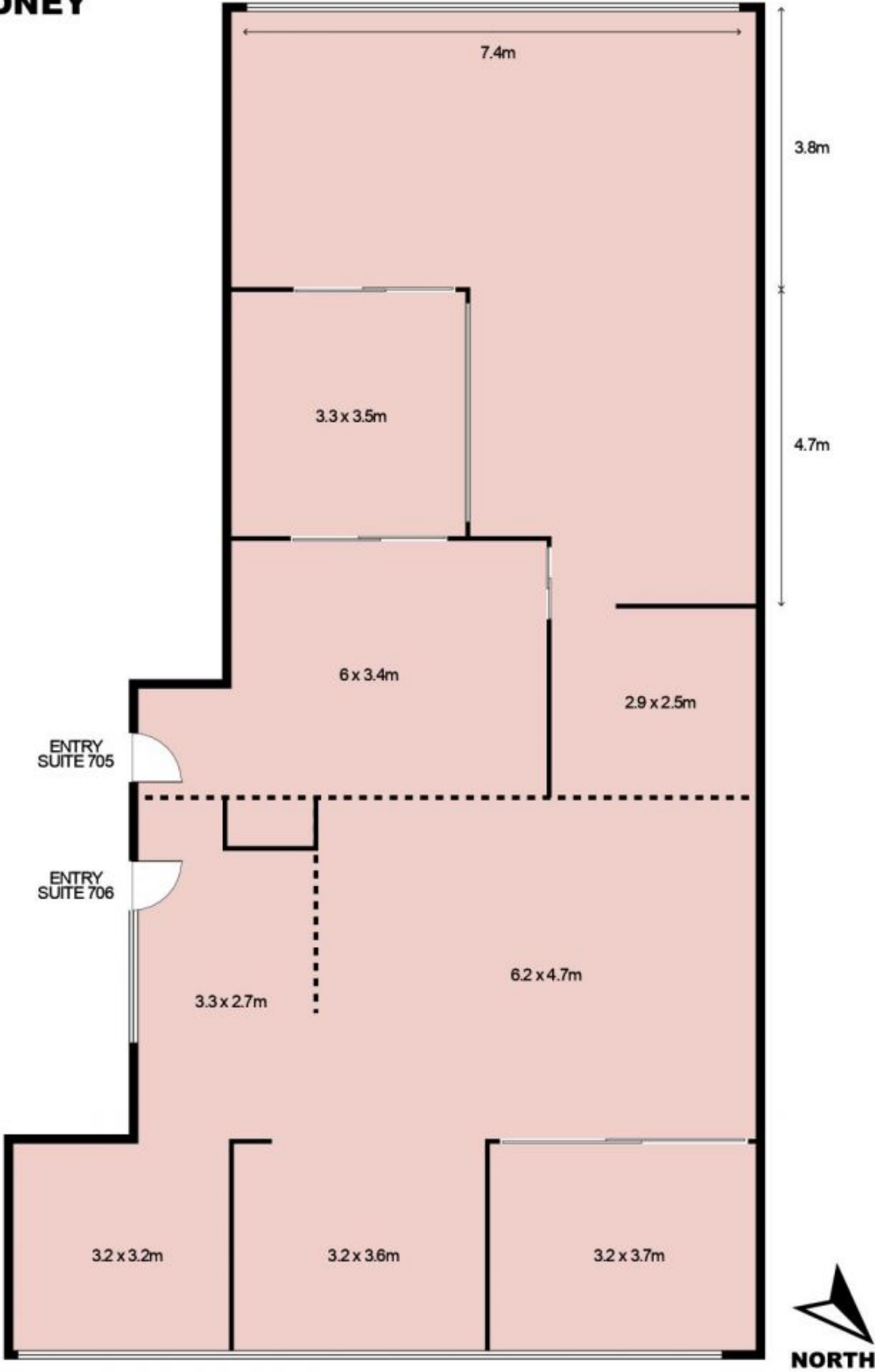

This floor plan is intended as a guide only. Layout dimension are approximate only. No representation or warranties of any nature whatsoever are given or intended. Any person using this information should rely on their own enquiries.