

2/185 Gloucester Street Sydney NSW

- Stylish commercial suite of unrivalled quality
- Vibrant, distinguished and inspired work space
- Classic New York warehouse style features
- Ultra high ceilings maximising light and space
- Exposed services and ceiling beams throughout
- Large windows with attractive tree line views
- Polished concrete floors and pendant lighting
- Imposing main reception with bespoke joinery
- Two highly impressive meeting/client rooms
- Full kitchen, bathroom and shower facilities
- Integrated storage and large break out space
- Two car spaces available with direct suite access
- Prestigious and iconic landmark CBD building
- Part of the admired Reynell Terraces complex
- Striking main lobby area with high spec finishes
- Highly coveted location near Circular Quay
- Close to Wynyard, Barangaroo and Martin Place

Building Size : 272 sqm
View : <https://www.noonanproperty.com.au/lease/nsw/sydney-city/sydney/commercial/offices/5999263>



Tim Noonan
02 9231 6000

2/185 Gloucester Street, THE ROCKS

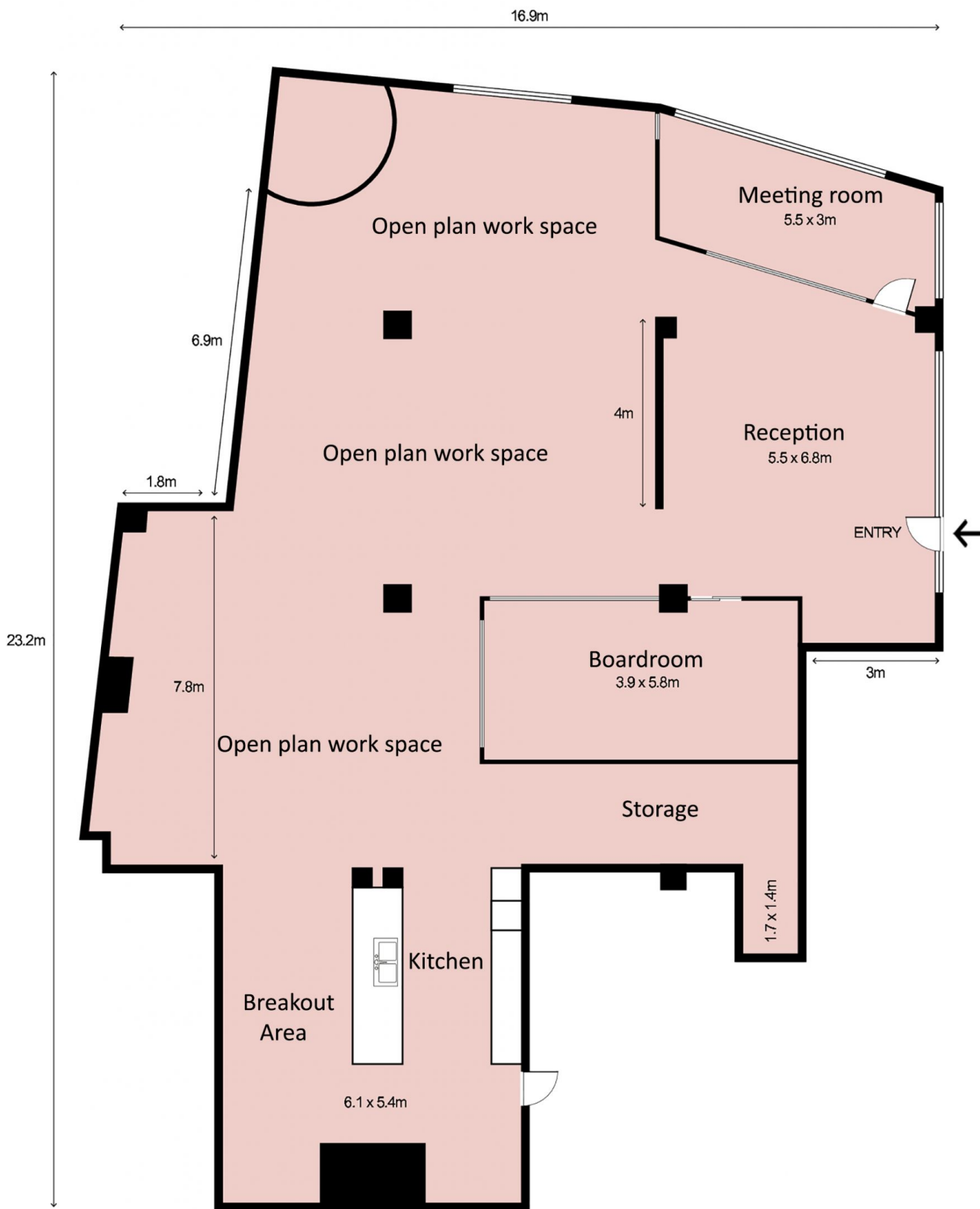

This floor plan is intended as a guide only. Layout dimension are approximate only. No representation or warranties of any nature whatsoever are given or intended. Any person using this information should rely on their own enquiries.

2/185 Gloucester Street, THE ROCKS

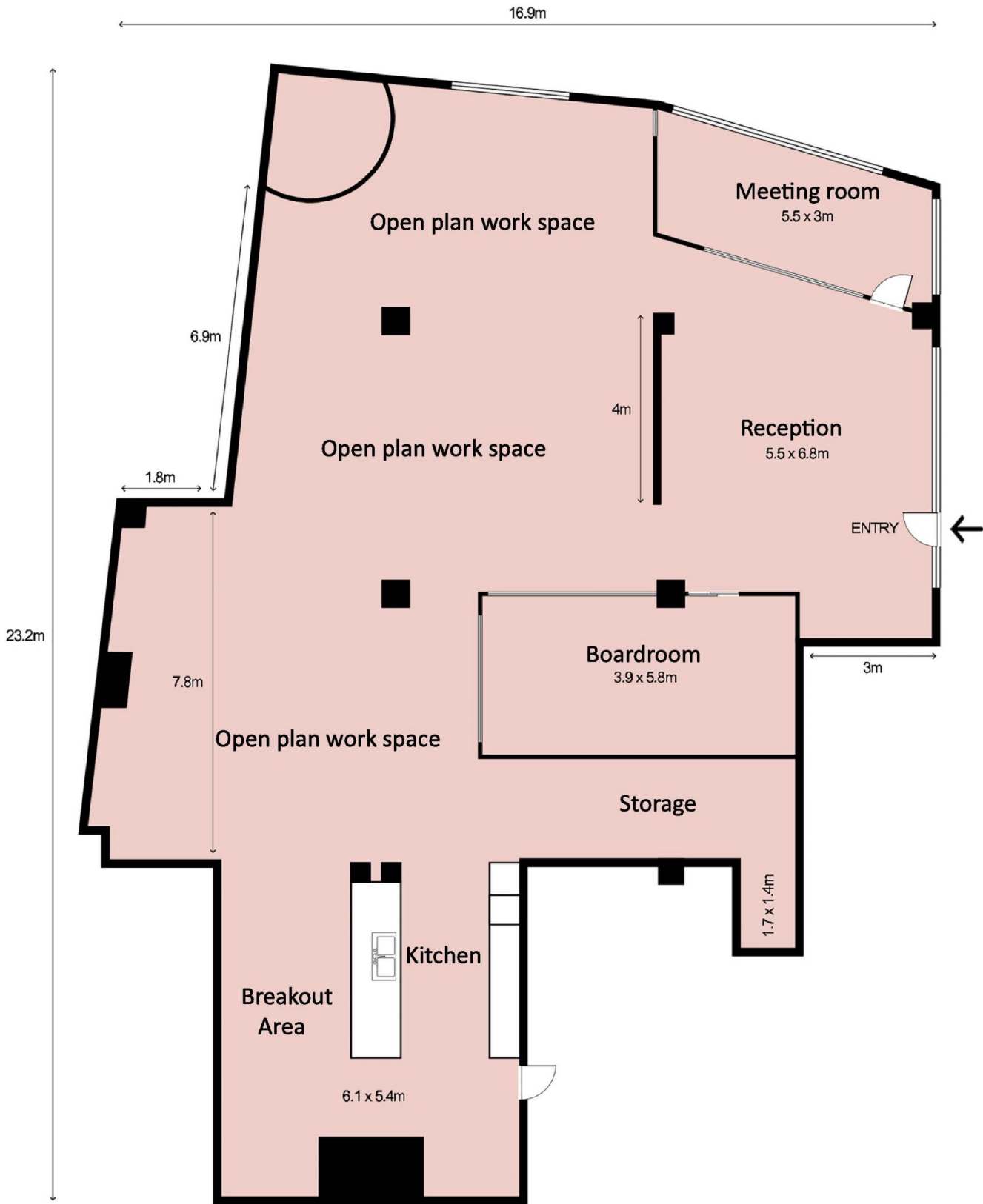

This floor plan is intended as a guide only. Layout dimension are approximate only. No representation or warranties of any nature whatsoever are given or intended. Any person using this information should rely on their own enquiries.