

NOONAN PROPERTY



1201/447 Kent Street Sydney NSW

Noonan Property has been exclusively appointed to offer Suite 1201 and Car Space 37, 447 Kent Street, Sydney for sale.

- Newly renovated strata property with parking
- Elevated positioning with outstanding light
- Security car space included on separate title
- Modern, stylish and impressive workspace
- Dual east and west facing window frontages
- Attractive views overlooking Darling Harbour
- Comprehensive fitout with glass partitioning
- Combination of offices and open workspaces
- 31% leased to longstanding quality tenant
- Efficient and easily sub dividable floor plan
- Direct and prominent lift lobby exposure
- Easy access to on-floor bathroom amenities
- Substantial commercial building with 4 lifts

Building Size : 274 sqm
View : <https://www.noonanproperty.com.au/sale/nsw/sydney-city/sydney/commercial/offices/5999300>



Tim Noonan
02 9231 6000



Ben Kennedy
0449 286 129

SUITE 1201 & 1201A 447 KENT STREET SYDNEY

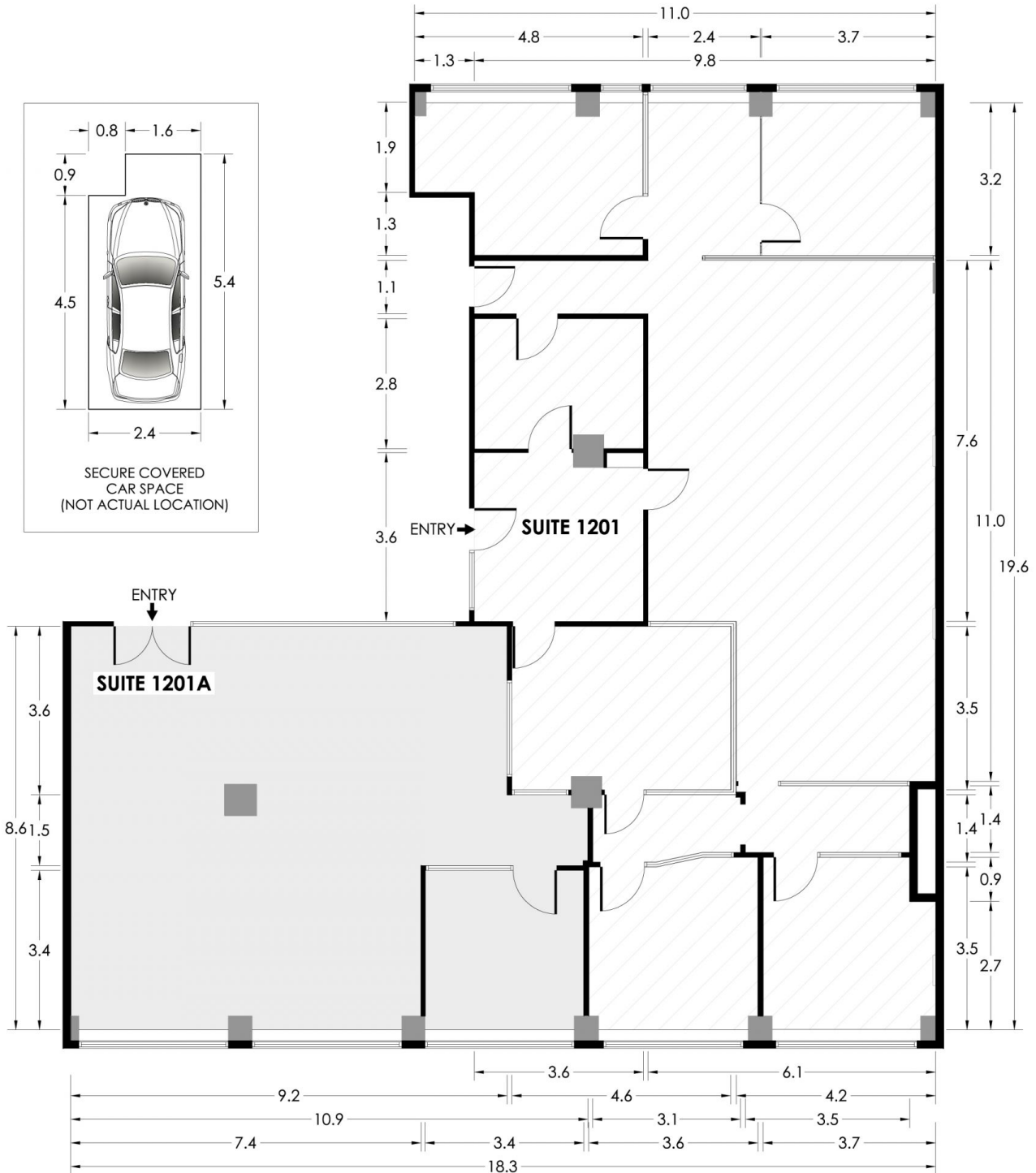

*PLANS SHOWN ONLY INDICATIVE OF LAYOUT. DIMENSIONS ARE APPROXIMATE.
Floor plan supplied by V-Mark Design Pty Ltd. This floor plan is provided for indicative purposes only.
Measurements are approximate and not to scale. The vendor, agency and supplier will accept no liability

**NOONAN
PROPERTY**

SUITE 1201 & 1201A 447 KENT STREET SYDNEY

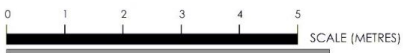

*PLANS SHOWN ONLY INDICATIVE OF LAYOUT. DIMENSIONS ARE APPROXIMATE.
 Floor plan supplied by V-Mark Design Pty Ltd. This floor plan is provided for indicative purposes only.
 Measurements are approximate and not to scale. The vendor, agency and supplier will accept no liability

**NOONAN
PROPERTY**