



## Shop 6/27 Park Street Sydney NSW

Noonan Property Sydney are pleased to offer for sale Shop 6, Park Regis, 27 Park Street, Sydney.

This sale represents an outstanding opportunity to acquire a quality and versatile retail investment property in the heart of Sydney's thriving midtown precinct near Martin Place, Town Hall and Hyde Park. Importantly, this property is also positioned directly opposite the highly anticipated Gadigal Station (formerly Pitt Street Metro Station) development, which is scheduled to open in 2024. This substantial development will significantly increase foot traffic in the area once completed.

The property is offered with a new 5+5 year lease to a popular food and beverage business trading as H & H Coffee. The business retails hot and cold drinks, fresh sandwiches, wraps, rolls and an assortment of pastries.

**Price** : \$1,850,000  
**Building Size** : 31 sqm  
**Land Size** : 31 sqm  
**View** : <https://www.noonanproperty.com.au/sale/nsw/sydney-city/sydney/commercial/rental/7892163>



**Tim Noonan**  
02 9231 6000

# SHOP 6/27 PARK STREET SYDNEY

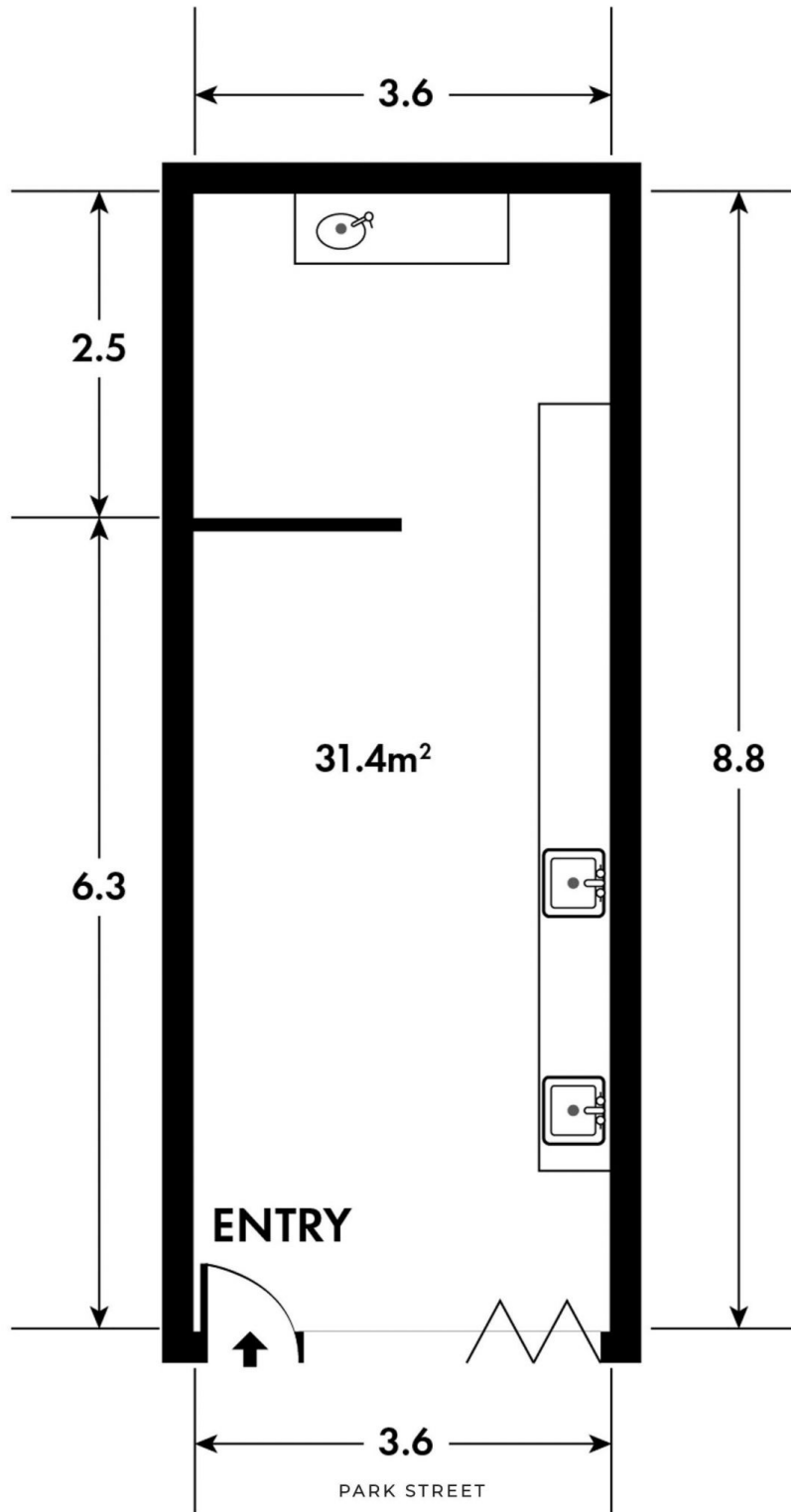

0 1 2 3 4 5

SCALE (METRES)

\*PLANS SHOWN ONLY INDICATIVE OF LAYOUT. DIMENSIONS ARE APPROXIMATE.  
Floor plan supplied by V-Mark Design Pty Ltd. This floor plan is provided for indicative purposes only. Measurements are approximate and not to scale. The vendor, agency and supplier will accept no liability for its accuracy. Interested parties are advised to make their own independent enquiries.

# NOONAN PROPERTY