



70 Pitt Street Sydney NSW

Noonan Property Sydney are pleased to present for lease Level 7, 70 Pitt Street, Sydney.

Suite 701

Size 212 sqm

Rental \$600 per sqm gross per annum (\$127,200 pa)

70 Pitt Street is situated in a high profile location near Wynyard, Martin Place and Circular Quay being one of Sydney's most distinguished business addresses. The building is also close walking distance to the new George Street Light Rail system along with Australia's largest mixed-use development, the \$6 billion Barangaroo precinct.

Tim Noonan

[For full version visit the website](https://www.noonanproperty.com.au/lease/nsw/sydney-city/sydney/commercial/offices/8068061)

Type	: Offices
Price	: \$600/m2 Gross PA
Building Size	: 212 sqm
Land Size	: 212 sqm
View	: https://www.noonanproperty.com.au/lease/nsw/sydney-city/sydney/commercial/offices/8068061



Tim Noonan
02 9231 6000

SUITE 701 & 702, LEVEL 7, 70 PITT STREET SYDNEY

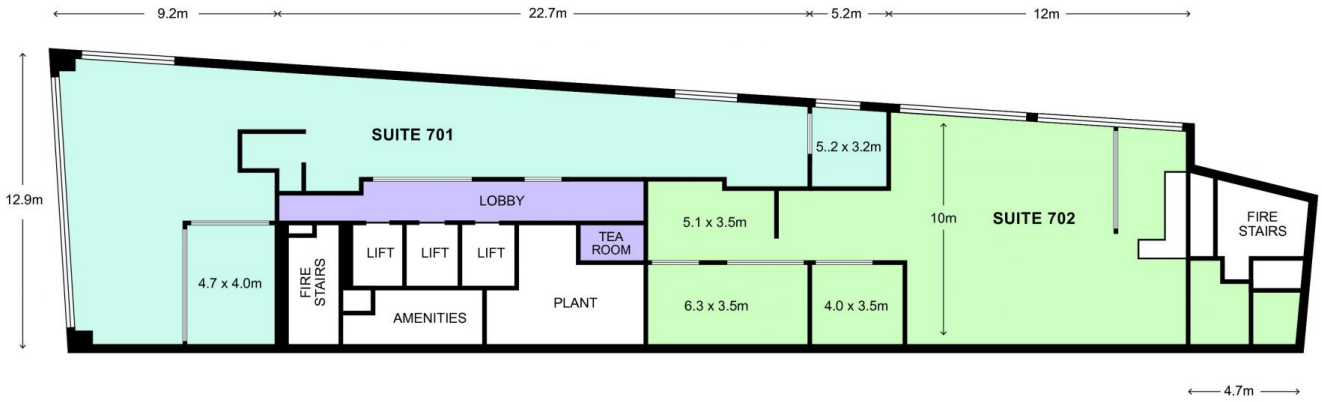

*PLANS SHOWN ONLY INDICATIVE OF LAYOUT. DIMENSIONS ARE APPROXIMATE.
This floor plan is provided for indicative purposes only.
Measurements are approximate and not to scale. The vendor, agency and supplier will accept no liability for its accuracy. Interested parties are advised to make their own independent enquiries.

NOONAN
PROPERTY